

## DUAL PLATE CHECK VALVE



ISO 9001

BUREAU VERITAS  
Certification



TÜVRheinland®  
PED/2014/68/EU



Certificate 3.1

**Size :** DN 40 to 600

**Ends :** Between flanges PN10/16 or PN25

**Min Temperature :** - 10°C

**Max Temperature :** + 90°C for NBR, 110°C for EPDM, 180°C for FKM

**Max Pressure :** 10 to 16 Bars ( according to DN )

**Specifications :** Vulcanized gasket

Horizontal or vertical position

Between flanges

**Materials :** Cast iron or stainless steel body

**HISPACONTROL<sup>HC</sup>**  
INSTRUMENTACION INDUSTRIAL

HISPACONTROL S.L.

Pº Delicias 65 Bis

28045 Madrid

Tel. 915 308 552

hc@hispacontrol.com

www.hispacontrol.com

## DUAL PLATE CHECK VALVE

**SPECIFICATIONS :**

- Vulcanized gasket
- Hoisting eye from DN200 to 600
- Short length
- Anti-corrosion stainless steel spring
- PTFE bushing
- Weak head loss
- Vertical position with ascendant fluid or horizontal position ( respect the flow direction indicated by the arrow )
- Between flanges PN10/16 or PN25
- Anti-corrosion epoxy painting RAL003 50-100 microns thickness for body of 370 and 371 types

**USE :**

- Heating, water distribution for **Ref. 370-371**
- Chemical and pharmaceutical industries, petrochemical industries, hydraulic installation for **Ref. 372**
- Min and max Temperature Ts : - 10°C to + 90°C ( 110°C temporarily ) for cast iron body with NBR gasket type **Ref.370**
- Min and max Temperature Ts : - 10°C to + 110°C for cast iron body with EPDM gasket type **Ref.371**
- Min and max Temperature Ts : - 10°C to + 180°C for stainless steel body with FKM gasket type **Ref.372**
- Max Pressure Ps : 16 bars up to DN300 included and 10 bars over
- **Do not use with pulsatory speed**

**HEAD LOSS GRAPH :**

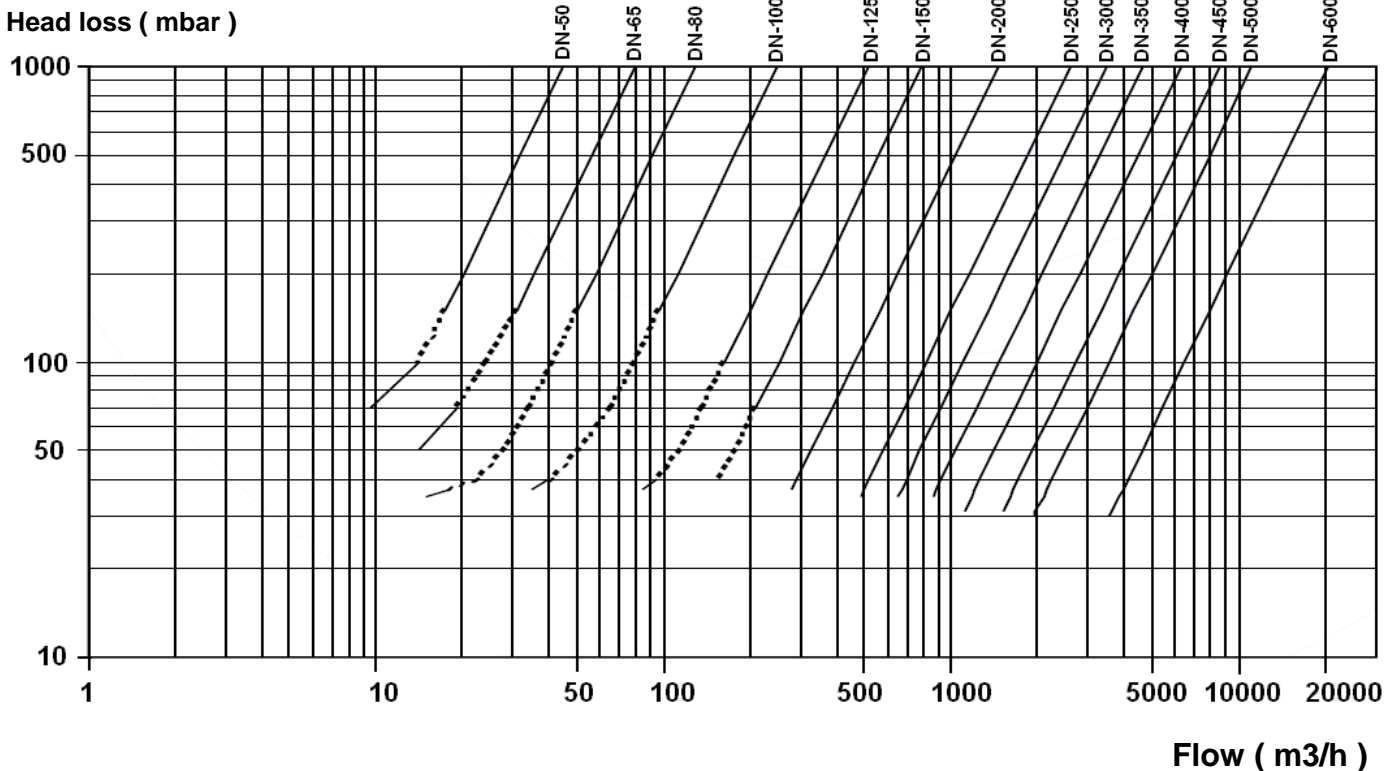

**OPENING PRESSURE ( in mbar ) :**

| DN                                     | 40  | 50  | 65  | 80  | 100 | 125 | 150 | 200 | 250 | 300 |
|--|-----|-----|-----|-----|-----|-----|-----|-----|-----|-----|
| <b>Horizontal position</b>             | 150 | 230 | 94  | 190 | 280 | 160 | 79  | 41  | 38  | 31  |
| <b>Vertical position ascend. fluid</b> | 190 | 260 | 114 | 230 | 320 | 180 | 95  | 57  | 58  | 56  |

## DUAL PLATE CHECK VALVE

**RANGE :**

- Double plate check valve with cast iron body and ductile iron disc between flanges PN10/16 **Ref. 370** From DN40 to DN 600
- Double plate check valve with cast iron body and stainless steel disc between flanges PN10/16 **Ref. 371** From DN50 to DN 600
- Double plate check valve with Stainless steel body and disc between flanges PN25 from DN 50 to 200 and PN10/16 from DN 250 to DN 600 **Ref. 372** From DN50 to 600

**MATERIALS DN40-80 :**

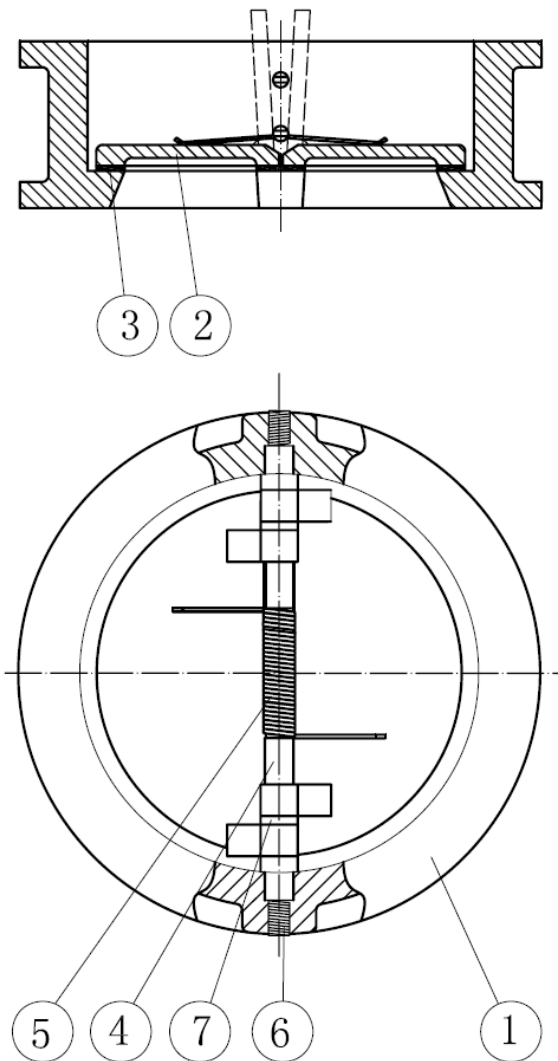

| Item | Designation | Materials 370                     | Materials 371           | Materials 372     |
|------|-------------|-----------------------------------|-------------------------|-------------------|
| 1    | Body        | Cast iron EN-GJL 250              | Cast iron EN-GJL 250    | SS ASTM A351 CF8M |
| 2    | Disc        | Nickel ductile iron EN-GJS 400-15 | SS ASTM A351 CF8M       | SS ASTM A351 CF8M |
| 3    | Seat        | NBR                               | EPDM                    | FKM               |
| 4    | Shaft       | SS 304                            | SS 316                  | SS 316            |
| 5    | Spring      | SS 304                            | SS 316                  | SS 316            |
| 6    | Screw       | Galvanized carbon steel           | Galvanized carbon steel | SS 316            |
| 7    | Spacer      | PTFE                              | PTFE                    | PTFE              |

**DUAL PLATE CHECK VALVE**

MATERIALS DN100 - 600 :

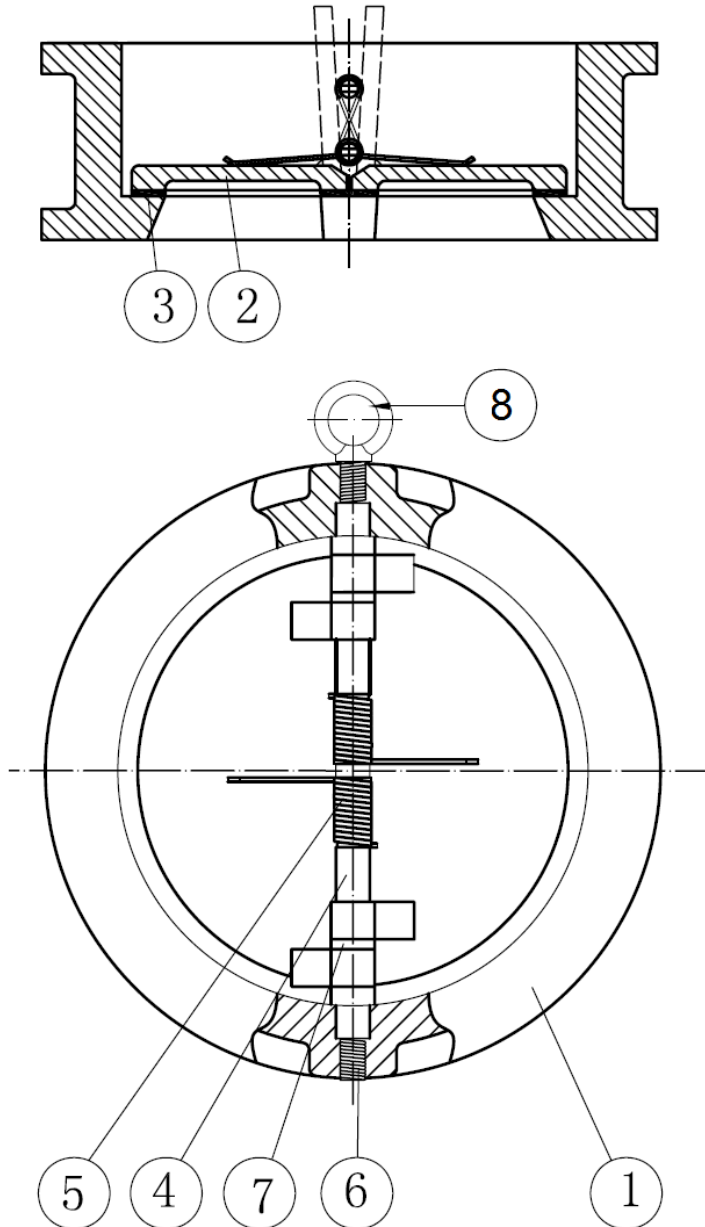

| Item | Designation                      | Materials 370                     | Materials 371           | Materials 372  |
|------|----------------------------------|-----------------------------------|-------------------------|----------------|
| 1    | Body                             | Cast iron EN-GJL 250              | Cast iron EN-GJL 250    | ASTM A351 CF8M |
| 2    | Disc                             | Nickel ductile iron EN-GJS 400-15 | ASTM A351 CF8M          | ASTM A351 CF8M |
| 3    | Seat                             | NBR                               | EPDM                    | FKM            |
| 4    | Shaft                            | SS 304                            | SS 316                  | SS 316         |
| 5    | Spring                           | SS 304                            | SS 316                  | SS 316         |
| 6    | Screw                            | Galvanized carbon steel           | Galvanized carbon steel | SS 316         |
| 7    | Spacer                           | PTFE                              | PTFE                    | PTFE           |
| 8    | Hoisting eye (from DN200 to 600) | SS 304                            | SS 304                  | SS 304         |

**DUAL PLATE CHECK VALVE**

**SIZE REF.370/371 ( in mm ):**

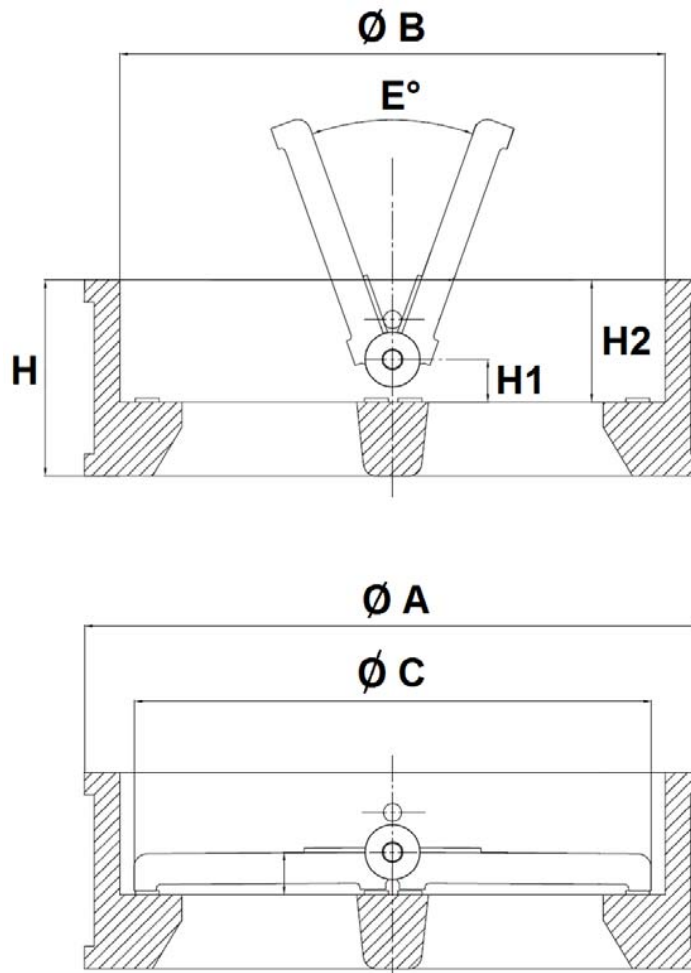

| Ref.    | DN            | 40   | 50   | 65   | 80   | 100   | 125   | 150   | 200   | 250   | 300   | 350   | 400   | 450   | 500   | 600   |
|---------|---------------|------|------|------|------|-------|-------|-------|-------|-------|-------|-------|-------|-------|-------|-------|
| 370/371 | H             | 43   | 54   | 54   | 57   | 64    | 70    | 76    | 95    | 108   | 144   | 184   | 191   | 203   | 213   | 222   |
|         | H1            | 12   | 14.4 | 16.9 | 19.9 | 21    | 22.3  | 22.5  | 28    | 34    | 37    | 35    | 37.5  | 42.2  | 39.5  | 48.5  |
|         | H2            | 33   | 43   | 43   | 45   | 47    | 51    | 54    | 69    | 71    | 100   | 120   | 123   | 122.6 | 132   | 138.5 |
|         | Ø A           | 82   | 109  | 129  | 144  | 164   | 194   | 220   | 275   | 330   | 380   | 440   | 491   | 541   | 596   | 697   |
|         | Ø B           | 56.5 | 70.5 | 83.5 | 91.5 | 115.5 | 142.5 | 169.5 | 220.5 | 275.5 | 325.5 | 356   | 406   | 467   | 514   | 616   |
|         | Ø C           | 52   | 60.5 | 75.8 | 80.5 | 104.5 | 130.3 | 155.9 | 201.2 | 257.2 | 303.3 | 345.9 | 388.6 | 431.2 | 486.8 | 607.6 |
|         | E°            | 0°   | 0°   | 0°   | 0°   | 0°    | 0°    | 0°    | 0°    | 0°    | 0°    | 20°   | 20°   | 20°   | 25°   | 25°   |
|         | Weight ( Kg ) | 1.6  | 1.62 | 2.3  | 3.14 | 4.5   | 6.7   | 9.05  | 16    | 26.9  | 38.9  | 80    | 106   | 128   | 158   | 225   |

**DUAL PLATE CHECK VALVE**

SIZE REF.372 (in mm.):

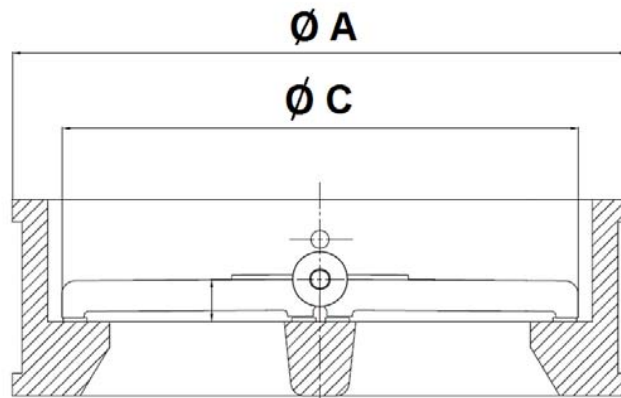
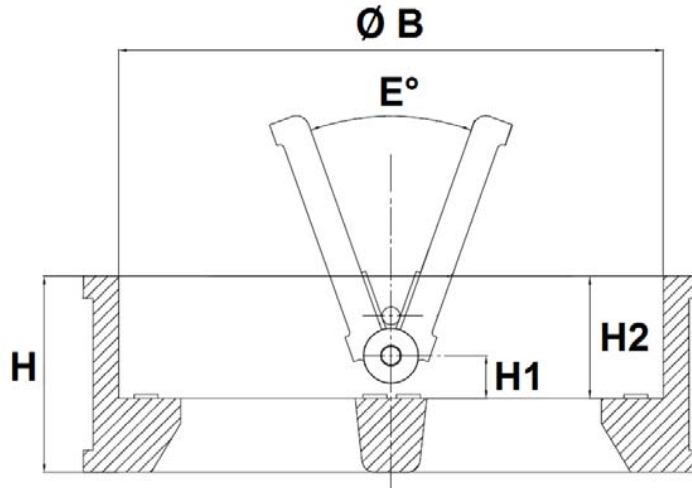

| Ref. | DN            | 50   | 65   | 80   | 100   | 125   | 150   | 200   | 250   | 300   | 350   | 400   | 450   | 500   | 600   |
|------|---------------|------|------|------|-------|-------|-------|-------|-------|-------|-------|-------|-------|-------|-------|
| 372  | H             | 54   | 54   | 57   | 64    | 70    | 76    | 95    | 108   | 144   | 184   | 191   | 203   | 213   | 222   |
|      | H1            | 14.4 | 16.9 | 19.9 | 21    | 22.3  | 22.5  | 28    | 34    | 37    | 35    | 37.5  | 42.2  | 39.5  | 48.5  |
|      | H2            | 43   | 43   | 45   | 47    | 51    | 54    | 69    | 71    | 100   | 120   | 123   | 122.6 | 132   | 138.5 |
|      | Ø A           | 109  | 129  | 144  | 170   | 196   | 226   | 285   | 330   | 380   | 440   | 491   | 541   | 596   | 698   |
|      | Ø B           | 70.5 | 83.5 | 91.5 | 115.5 | 142.5 | 169.5 | 220.5 | 275.5 | 325.5 | 356   | 406   | 467   | 514   | 616   |
|      | Ø C           | 60.5 | 75.8 | 80.5 | 104.5 | 130.3 | 155.9 | 201.2 | 257.2 | 303.3 | 345.9 | 388.6 | 431.2 | 486.8 | 607.6 |
|      | E°            | 0°   | 0°   | 0°   | 0°    | 0°    | 0°    | 0°    | 0°    | 0°    | 20°   | 20°   | 20°   | 25°   | 25°   |
|      | Weight ( Kg ) | 1.84 | 2.4  | 3.35 | 5.05  | 6.68  | 9.6   | 18.07 | 26.9  | 38.9  | 80    | 106   | 128   | 158   | 225   |

## DUAL PLATE CHECK VALVE

### STANDARDS :

- Fabrication according to ISO 9001 : 2015
- DIRECTIVE 2014/68/EU : CE N° 0035  
Risk Category III Module H
- Certificate 3.1 on request
- Designing according to API 594
- Pressure tests according to API 598, table 6
- Length according to EN 558 Series 50
- Between flanges according to EN 1092-1 PN10/16 for cast iron check valves Ref.370- 371
- Between flanges according EN 1092-1 PN10/16/25 for stainless steel check valves Ref.372

### INSTALLATION POSITIONS :

Vertical position ( ascendant fluid )

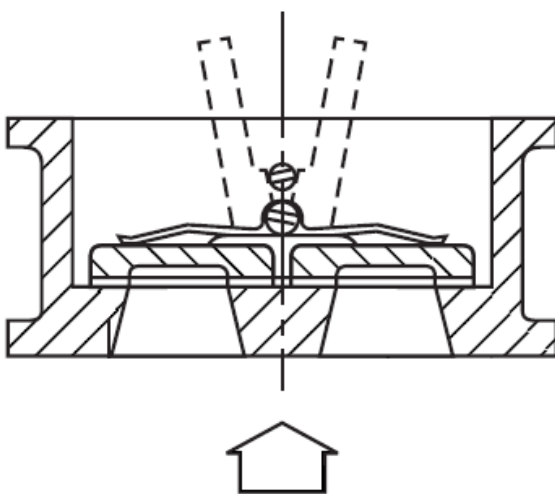

Horizontal position

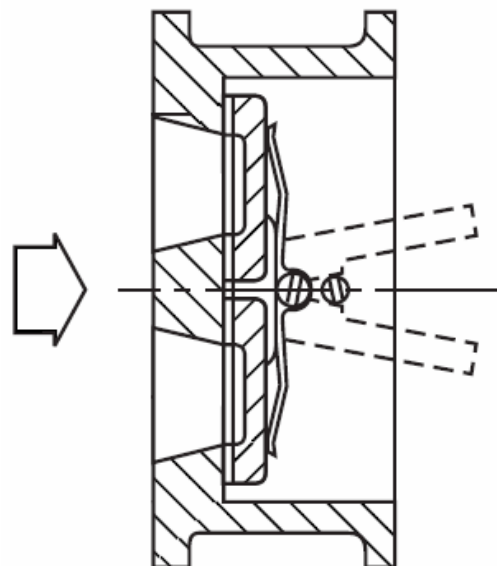

**ADVICE :** Our opinion and our advice are not guaranteed and SFERACO shall not be liable for the consequences of damages. The customer must check the right choice of the products with the real service conditions.



## DUAL PLATE CHECK VALVE

### INSTALLATION INSTRUCTIONS

#### GENERAL GUIDELINES :

- Ensure that the check valves to be used are appropriate for the conditions of the installation (type of fluid, pressure and temperature).
- Be sure to have enough valves to be able to isolate the sections of piping as well as the appropriate equipment for maintenance and repair.
- Ensure that the valves to be installed are of correct strength to be able to support the capacity of their usage.

#### INSTALLATION INSTRUCTIONS :

- **Before installing the check valves, clean and remove any objects from the pipes** (in particular bits of sealing and metal) which could obstruct and block the valves.
- **Ensure that both connecting pipes either side of the check valve (upstream and downstream) are aligned (if they're not, the valves may not work correctly).**
- **Make sure that the two sections of the pipe (upstream and downstream) match, the check valve unit will not absorb any gaps. Any distortions in the pipes may affect the tightness of the connection, the working of the check valve and can even cause a rupture.** To be sure, place the kit in position to ensure the assembling will work.
- Make sure there is enough space so that the disc can be opened totally in the pipe.
- If there is a direction changing or if there's another material, it's better to take away the check valve so that it is outside the turbulence area ( **between 3 and 5 times the ND before and after** ).
- After a pump please refer to **FD CEN/TR 13932** to install the check valve :
  - If it is essential to keep priming the pump, a non-return check valve can be fitted to the suction pipe at a distance **L1 ( straight length suction ) > 10xD1 (diameter suction )**  
The check valve is designed to meet the maximum flow rate in service
  - In other cases, the non-return check valve is mounted on the discharge pipe at a distance of **L2 (straight length at discharge) > 3xD2 (diameter at discharge)**
- Respect the flow direction indicated by the arrow